

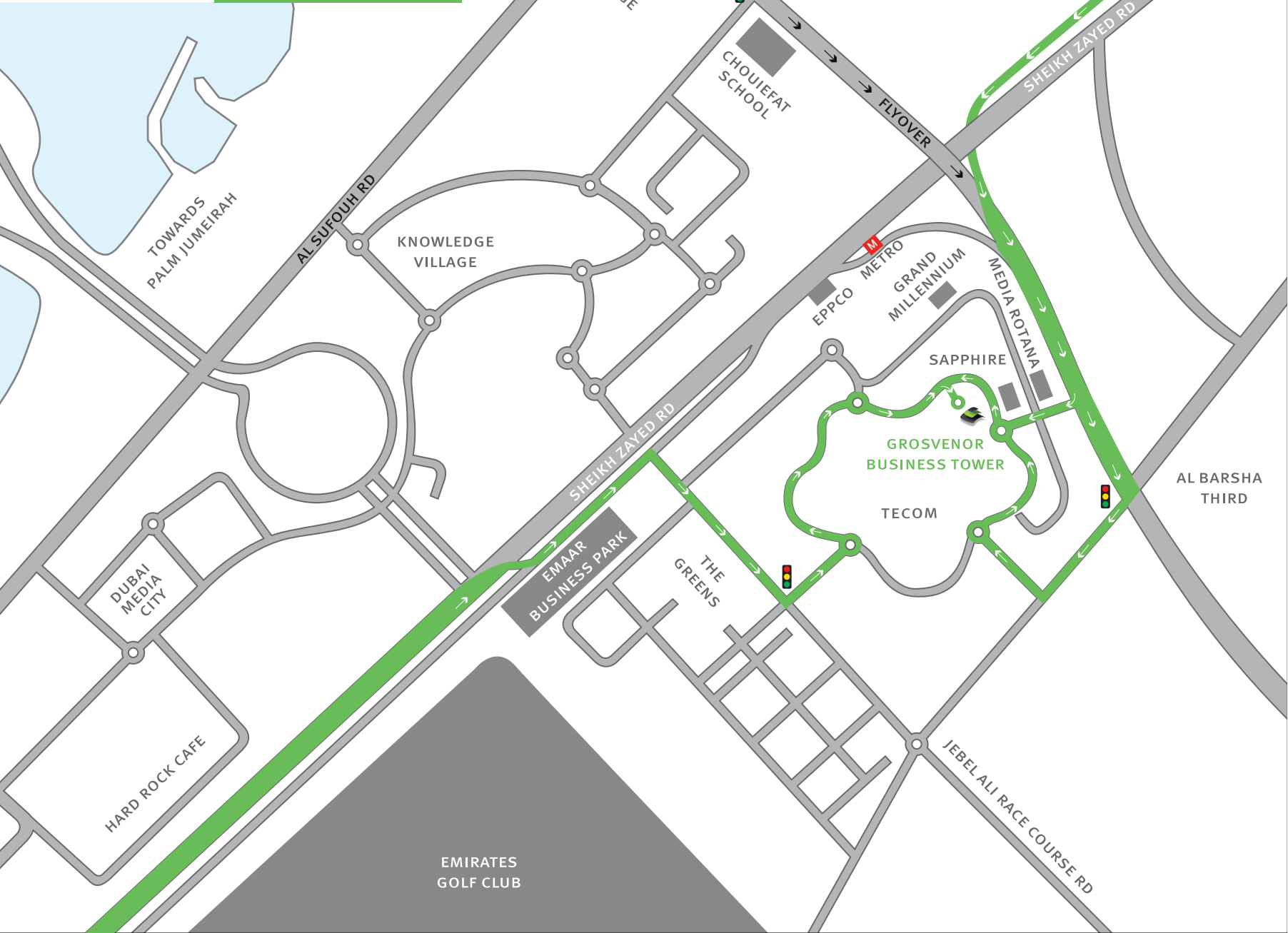

Grosvenor Business Tower
Office 912, TECOM
P.O. Box 74599 Dubai, UAE
Tel: +971 4 435 6460
Fax: +971 4 435 6461
stratum@stratum.ae
www.stratum.ae



COMING FROM DUBAI

- Take the Hessa Street exit to Barsha which is located before Wellington International School.
- Enter the tunnel towards Barsha and as you exit the tunnel, filter to the right and take the first right turn (after the Media Rotana Hotel). At the roundabout, take a right
- At the next roundabout do a u-turn and take the first right and then left round a mini roundabout. Grosvenor Business Tower is the building on the right.
- Alternatively, if you miss the first right after the tunnel continue straight to the intersection and take a right. Then take the next right and at the roundabout take a right, follow the road round and over the second roundabout - now follow the above point.

COMING FROM AL SUFOUH

- Take the turn by Dubai College and follow the road over the flyover.
- As you come off the flyover, filter to the right and turn right at the roundabout
- Then take the next right and at the first round about take a right, follow the road round and over the second roundabout
- Go to the third roundabout and do a u-turn and take the first right and then left round a mini roundabout and Grosvenor Business Tower is the building on the right.

COMING FROM ABU DHABI

- Take the exit onto the slip road, located near Emaar Business Park.
- Follow the slip road passed Emaar Business Park, take the exit for the Greens, then get into the left lane and at the signal turn left.
- Take a left at the first roundabout and carry on straight over the next roundabout.
- Take the first right and then left round a mini roundabout and Grosvenor Business Tower is the building on the right

M The Dubai Internet City Metro Station on the Red Line is in close proximity to TECOM and Grosvenor Business Tower.